

# EDGE-O-DOCKLEVELER - PP-3072

APPROX WEIGHT: 694.75 lbs.  
DOES NOT INCLUDE WEIGHT OF POWER OR PACKAGING!!!

\*\*\* ANY ADDITIONS, DELETIONS, OR OMISSIONS MUST BE CORRECTED ON THIS DRAWING AS THIS DRAWING WILL BE CONSIDERED ALL INCLUSIVE \*\*\*  
ALL GRAPHICS PROVIDED ARE FOR REFERENCE ONLY. IF CERTAIN DIMENSIONS ARE CRITICAL PLEASE VERIFY THOSE DIMENSIONS WITH YOUR SALESPERSON

\*\*HAND PUMP NOT SHOWN IN FRONT OR RIGHT VIEW\*\*

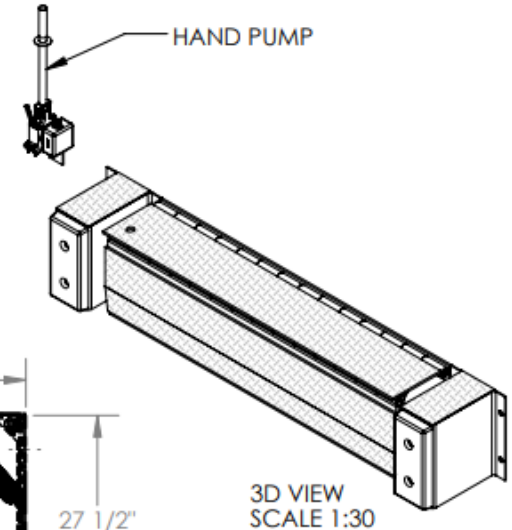
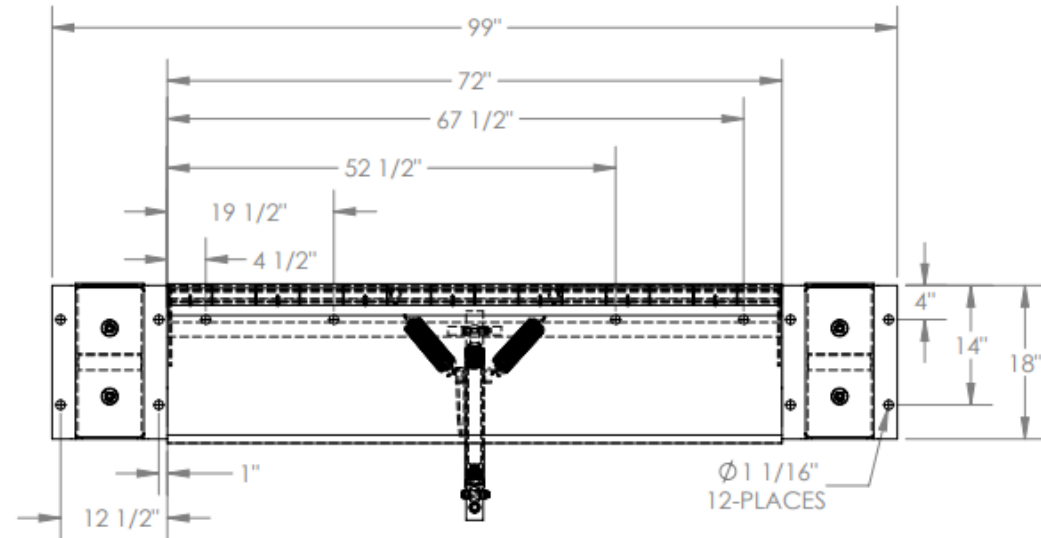

## STANDARD FEATURES

MODEL NUMBER IS PP-3072  
OVERALL WIDTH IS 99"  
DECK WIDTH IS 72"  
OVERALL DEPTH WITH RAMP OUT IS 29 13/16"  
BUMPER PROJECTION IS 17 1/2"  
UNIFORM CAPACITY IS 30,000 LBS.  
5" ABOVE / 5" BELOW SERVICE RANGE  
HYDRAULIC HAND PUMP OPERATION  
RECOMMENDED FOR DOCKS AT LEAST 48" HIGH.  
INCLUDES HAND PUMP, WALL-MOUNT BRACKET,  
CYLINDER, HYDRAULIC LINES AND OIL.  
TREADPLATE RAMP & DECK CONSTRUCTION

## SPECIAL FEATURES

NONE

DIMENSION TOLERANCE  $\pm 1/4"$

APPROVAL

I, THE UNDERSIGNED, AGREE THAT THE PRODUCT AS REPRESENTED SATISFIES DESIGN AND DIMENSION REQUIREMENTS. I ALSO ACKNOWLEDGE MY DUTY TO CONFIRM PRODUCT AND INSTALLATION COMPLIANCE WITH ALL APPLICABLE FEDERAL, STATE AND LOCAL REGULATIONS AND STANDARDS.

**ANY MODIFIED UNITS ARE NON-RETURNABLE**

As drawn     As marked

Signed: \_\_\_\_\_ Date: \_\_\_\_\_

Printed Name: \_\_\_\_\_

LEAD TIME WILL START UPON RECEIPT OF SIGNED APPROVAL DRAWING

FOR INTERNAL USE ONLY PROJECT SIGN OFF	
SALES	
ENG.	
FAB.	
POWER	

DISTRIBUTOR'S NAME:		P.O.#	X
		W.O.#	X
DRAWN BY:	M.WILSON	DATE:	12/19/2012
REFERENCE:	X	SCALE:	1:20
QUOTED LEAD TIME:	X	QUOTE #	X
			FILE NAME: 06-007-003