

ALUMINUM CHANNEL PLATFORM TRUCK-SDD-3048

APPROX WEIGHT: 98.47 lbs.
DOES NOT INCLUDE WEIGHT OF POWER OR PACKAGING!!!
ANY ADDITIONS, DELETIONS, OR OMISSIONS MUST BE CORRECTED ON THIS DRAWING AS THIS DRAWING WILL BE CONSIDERED ALL INCLUSIVE

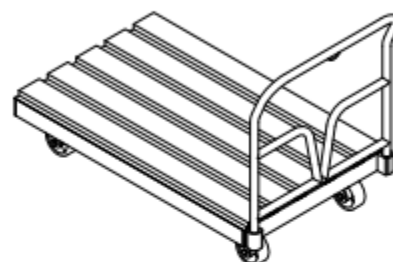
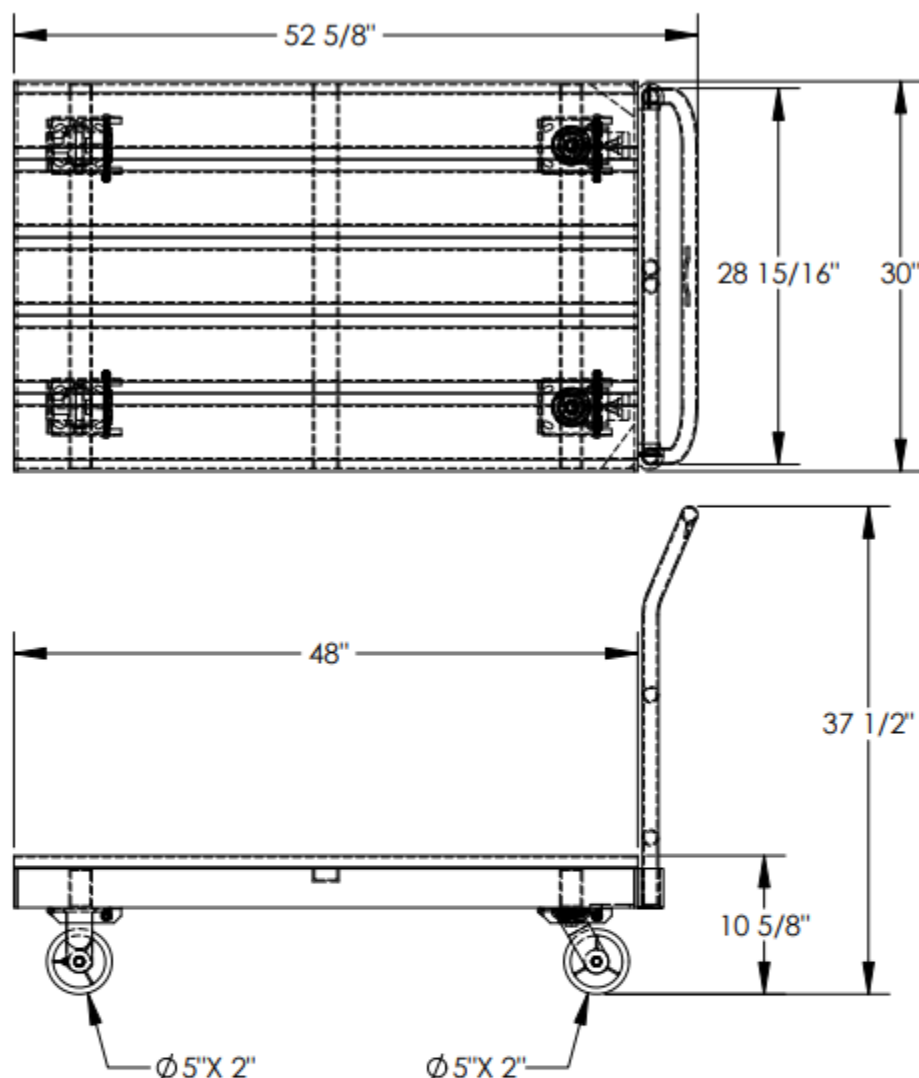

3D VIEW SHOWN FOR
REFERENCE ONLY

FOR INTERNAL USE ONLY PROJECT SIGN OFF	
SALES	
ENG.	
FAB.	
POWER	

STANDARD FEATURES

MODEL NUMBER IS SDD-3048
UNIFORM CAPACITY IS 3600 LBS.
OVERALL WIDTH IS 30"
USABLE WIDTH IS 30"
OVERALL LENGTH IS 52 5/8"
USABLE LENGTH IS 48"
OVERALL HEIGHT IS 37 1/2"
PLATFORM HEIGHT IS 10 5/8"
(2) Ø5 X 2 POLY-ON-STEEL
SWIVEL CASTERS
(2) Ø5 X 2 POLY-ON-STEEL
RIGID CASTERS
HANDLE WIDTH IS 28 15/16"
ALUMINUM CONSTRUCTION

SPECIAL FEATURES

NONE

ALL GRAPHICS PROVIDED ARE FOR REFERENCE ONLY.
IF CERTAIN DIMENSIONS ARE CRITICAL PLEASE VERIFY
THOSE DIMENSIONS WITH YOUR SALESPERSON

APPROVAL

I, THE UNDERSIGNED, AGREE THAT THE PRODUCT AS
REPRESENTED SATISFIES DESIGN AND DIMENSION
REQUIREMENTS. I ALSO ACKNOWLEDGE MY DUTY TO
CONFIRM PRODUCT AND INSTALLATION
COMPLIANCE WITH ALL APPLICABLE FEDERAL, STATE
AND LOCAL REGULATIONS AND STANDARDS.

ANY MODIFIED UNITS ARE NON-RETURNABLE

[] As drawn [] As marked

Signed: _____ Date: _____

Printed Name: _____

LEAD TIME WILL START UPON RECEIPT OF SIGNED APPROVAL DRAWING

DISTRIBUTOR'S NAME:		P.O.#
		X
		W.O.#
		X
DRAWN BY: ND		DATE: 12/21/05
REFERENCE: X		SCALE: 1:13
QUOTED LEAD TIME: X		QUOTE #
		X
		FILE NAME:
		33-007-044