

# ALUMINUM STEP STAND - SSA-3W-KD-Y

APPROX WEIGHT: 29.74 lbs.  
DOES NOT INCLUDE WEIGHT OF POWER OR PACKAGING!!!

\*\*\* ANY ADDITIONS, DELETIONS, OR OMISSIONS MUST BE CORRECTED ON THIS DRAWING AS THIS DRAWING WILL BE CONSIDERED ALL INCLUSIVE \*\*\*  
ALL GRAPHICS PROVIDED ARE FOR REFERENCE ONLY. IF CERTAIN DIMENSIONS ARE CRITICAL PLEASE VERIFY THOSE DIMENSIONS WITH YOUR SALESPERSON

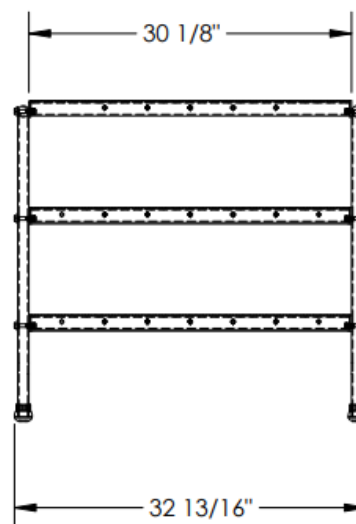
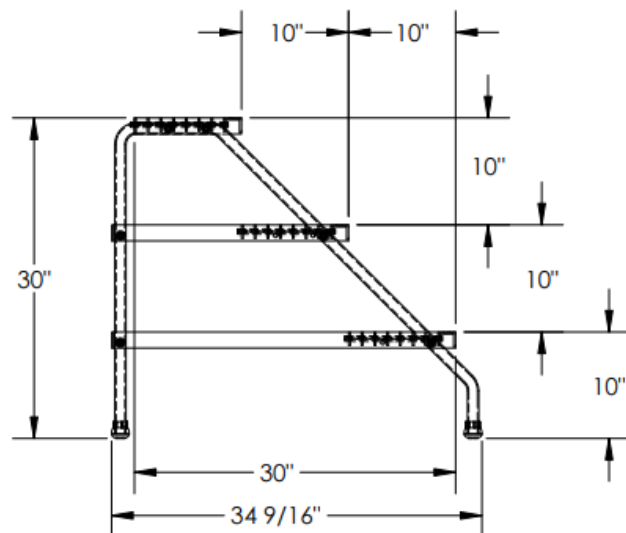

## STANDARD FEATURES

MODEL NUMBER IS SSA-3W-KD-Y  
TRIPLE STEP UNIT  
OVERALL WIDTH IS 32 13/16"  
USEABLE WIDTH IS 30 1/8"  
OVERALL LENGTH IS 34 9/16"  
USEABLE LENGTH IS 30"  
OVERALL HEIGHT IS 30"  
MAX CAPACITY IS 500 LBS  
YELLOW POWDER COAT FINISH

## SPECIAL FEATURES

NONE

DIMENSION TOLERANCE  $\pm 1/4"$

<b>APPROVAL</b>	I, THE UNDERSIGNED, AGREE THAT THE PRODUCT AS REPRESENTED SATISFIES DESIGN AND DIMENSION REQUIREMENTS. I ALSO ACKNOWLEDGE MY DUTY TO CONFIRM PRODUCT AND INSTALLATION COMPLIANCE WITH ALL APPLICABLE FEDERAL, STATE AND LOCAL REGULATIONS AND STANDARDS.	
	<b>ALL SPECIAL UNITS ARE NON-RETURNABLE</b>	
	[ ] As drawn [ ] As marked	
	Signed: _____	Date: _____
LEAD TIME WILL START UPON RECEIPT OF SIGNED APPROVAL DRAWING		

FOR INTERNAL USE ONLY PROJECT SIGN OFF		DISTRIBUTOR'S NAME: _____		P.O.# _____	
SALES	_____	DRAWN BY: BCN		W.O.# _____	
ENG.	_____	DATE: 2/8/2016		SALES: X	
FAB.	_____	REFERENCE: X		FILE NAME: _____	
POWER	_____	QUOTED LEAD TIME: X		SCALE: 1:16	
		QUOTE # Y		44-007-592-001	